

USER MANUAL

P I E G A C O N N E C T P L U S

E X P E C T M O R E

CONTENT

1	CONTENT	2
2	IMPORTANT SAFETY INSTRUCTIONS.....	3
3	PIEGA CONNECT PLUS AT A GLANCE.....	4
	3.1 SCOPE OF DELIVERY	4
	3.2 INTEGRATED STREAMING CLIENTS.....	5
	3.2.1 SPOTIFY CONNECT	5
	3.2.2 GOOGLE CHROMECAST BUILT-IN	5
	3.2.3 APPLE AIRPLAY	5
	3.2.4 ROON READY	5
	3.3 PIEGA ROOMCONTROL APP.....	6
4	OPERATING ELEMENTS	7
	4.1 PIEGA CONNECT PLUS AT A GLANCE.....	7
	4.2 REMOTE CONTROL AT A GLANCE.....	8
5	CONNECT TO LOCAL NETWORK (WIFI).....	9
6	WIRELESS CONNECTION TO YOUR SPEAKERS	9
	6.1 CONFIGURE THE SPEAKER GROUP	10
	6.2 TRI-BAND 2.4/5.2/5.8GHZ	10
7	CONNECT YOUR REMOTE CONTROL.....	11
8	TV CONNECTIVITY OPTIONS.....	11
	8.1 HDMI ARC CONNECTION	11
9	BLUETOOTH CONNECTION.....	12
10	MUTE / ON / OFF.....	13
11	INPUT SOURCE SELECTION.....	13
12	FIRMWARE UPDATE	14
13	TECHNICAL DATA.....	14
14	DECLARATION OF CONFORMITY	15

2 IMPORTANT SAFETY INSTRUCTIONS

Read all safety instructions carefully.

1. Heed all warnings.
2. Follow all instructions and recommendations.
3. Do not use this apparatus near water.
4. Clean with dry and soft cloth only.
5. Do not install near any heat sources such as radiators, heat registers, stoves, or other devices that produce heat.
6. Protect the power cord from being stepped on or pinched, particularly at plugs, convenience receptacles, and at the point they exit from the apparatus.
7. Only use accessories or attachments approved by the manufacturer.
8. Do not defeat the safety purpose of the polarized type plug. If the provided plug does not fit into your outlet, consult an electrician for replacement of the obsolete outlet.
9. Unplug this apparatus during lightning storms or when unused for long periods of time.
10. Refer all servicing to qualified personnel. Servicing is required if the apparatus has been damaged in any way, e.g. the power supply cord or plug is damaged, liquid has been spilled or objects have fallen into the apparatus. Equally if it has been exposed to rain or moisture, does not operate normally, or has been dropped.
11. The power plug should be easily accessible to disconnect the equipment.
12. Warning: To reduce the risk of fire and electric shock, do not expose this apparatus to rain or moisture.
13. Do not expose the apparatus to dripping or splashing and do not place objects filled with liquids, such as vases, on the apparatus.
14. Maintain 150 mm safety clearance all around the apparatus to ensure adequate ventilation.
15. Do not place objects with naked flames, such as lit candles on the apparatus.
16. This apparatus is approved for indoor use only.

3 PIEGA CONNECT PLUS AT A GLANCE

3.1 SCOPE OF DELIVERY

The scope of delivery includes:

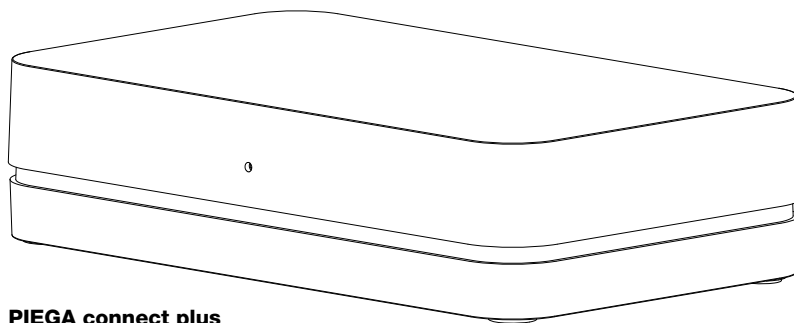

PIEGA connect plus

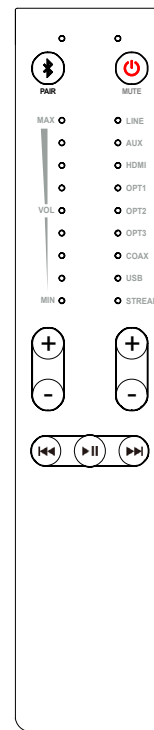

Remote control

Also included:

- Power supply
- External antenna

3.2 INTEGRATED STREAMING CLIENTS:

The PIEGA connect plus comes with the following pre-installed streaming clients: Google Chromecast, Spotify Connect, Apple AirPlay, Roon Ready.

3.2.1 SPOTIFY CONNECT

Spotify Connect allows you to play your music directly from the Spotify app to your PIEGA connect plus.



The Spotify software is subject to third party licenses found here: <https://www.spotify.com/connect/third-party-licenses>.

Simply use your smartphone, tablet or computer to remotely control listening on another device. Learn more on [spotify.com/connect](https://www.spotify.com/connect).

3.2.2 GOOGLE CHROMECAST BUILT-IN

Google Chromecast supports various music platforms and radio stations. With Google Chromecast built-in you can easily play music from your mobile device to your PIEGA connect plus.



Chromecast built-in is a trademark of Google LLC.

3.2.3 APPLE AIRPLAY

Apple AirPlay lets you share music from your Apple devices to your loudspeakers. And what you share always stays personal and private.



3.2.4 ROON READY

Roon Ready network devices have Roon's streaming technology built in, and are certified by Roon Labs to provide the highest level of quality and performance in network streaming: <https://roonlabs.com>



3.3 PIEGA ROOMCONTROL APP

Every room has individual acoustic properties that may have a substantial impact on sound reproduction. Our PIEGA Control App with integrated PIEGA RoomControl function recognises these factors in a quick and easy way, calibrates your speakers accordingly and balances negative effects so that you will get the most from your high-quality speakers. The PIEGA RemoteControl function replaces the wireless remote control if you wish to operate all functions conveniently from your smartphone.

The RoomControl app will be available from Spring 2022 in your Google Play or Apple app store.

4 OPERATING ELEMENTS

4.1 PIEGA CONNECT PLUS AT A GLANCE

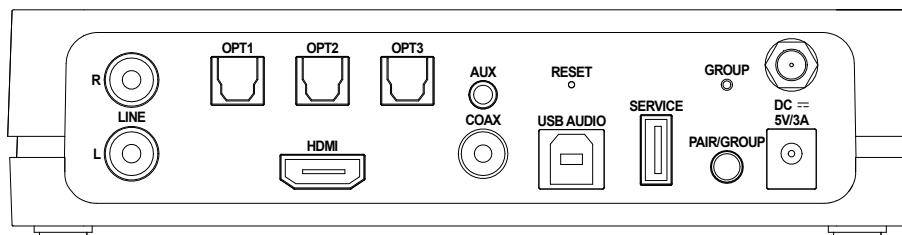

LINE	Analog stereo input RCA
OPT1 - 3	Digital optical input S/PDIF
HDMI ARC	HDMI input to connect your TV
AUX	Analog stereo input 3.5 mm jack
COAX	Digital coaxial input S/PDIF
RESET	Resets the apparatus to factory default
USB AUDIO	PC/MAC input for playback from your computer via USB
SERVICE	USB input for firmware updates
GROUP INDICATOR	Indicates the connection status and the selected loudspeaker group
PAIR/GROUP	Button to select the loudspeaker group and pair the remote control
DC 5V/3A	Connects the external power supply

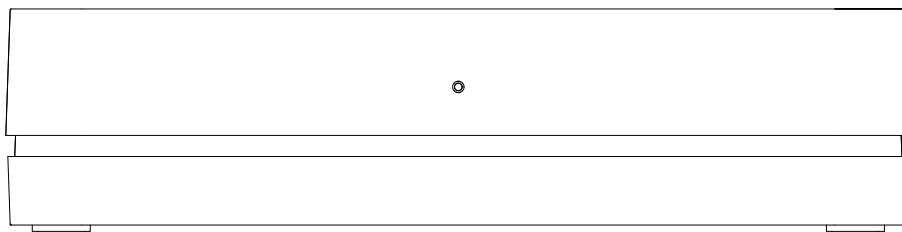

WIFI INDICATOR	Indicates the WIFI connection status
-----------------------	--------------------------------------

4.2 REMOTE CONTROL AT A GLANCE

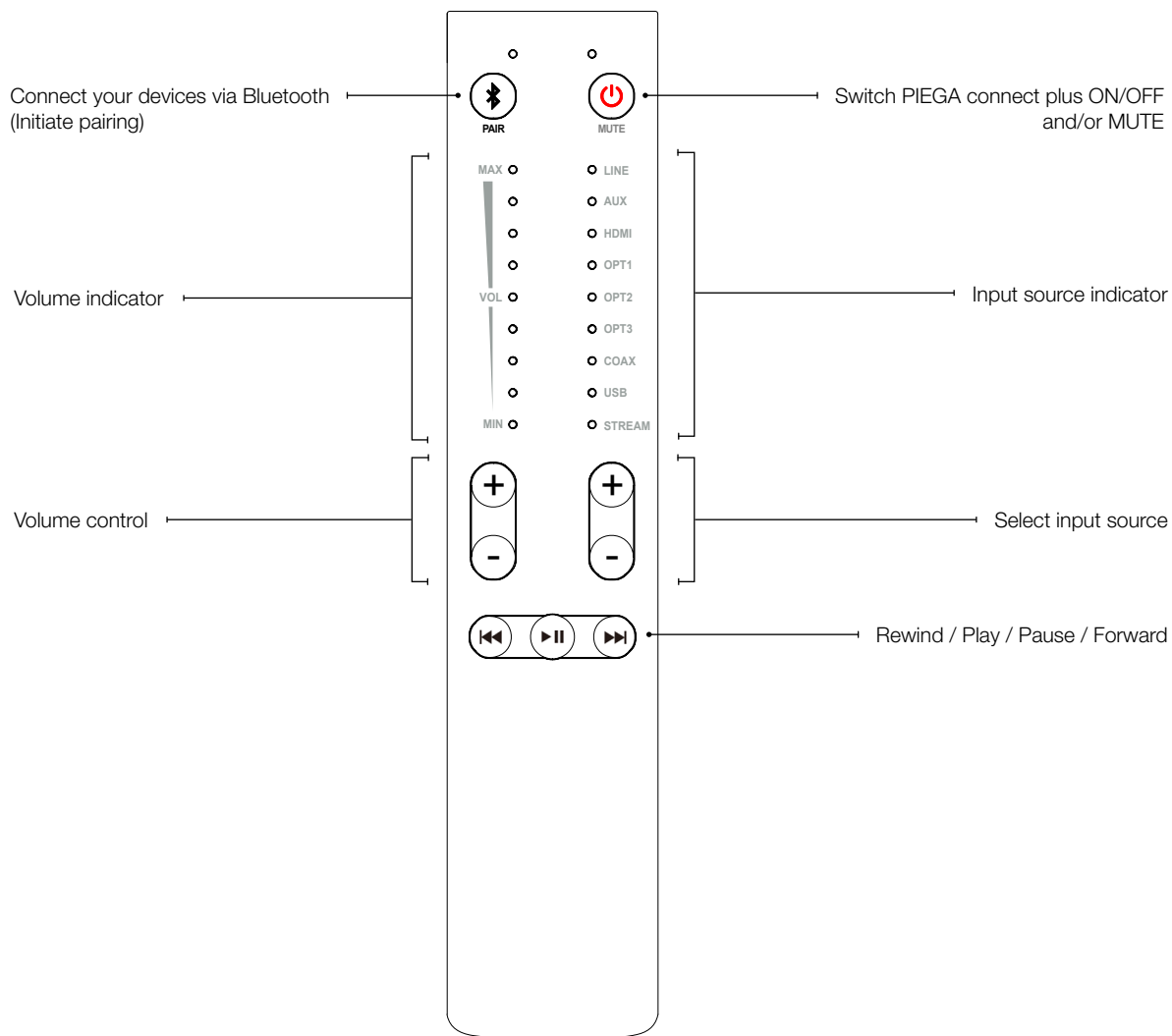

5 CONNECT TO LOCAL NETWORK (WIFI)

Google Home offers a simple way of integrating your speakers into your local network and operating them easily:

1. Download the Google Home app on your smart device.
2. Power your speakers.
IMPORTANT: Ensure power is connected for at least 1 minute for Google Home to detect your PIEGA connect plus.
3. Open the Google Home app on your smart device.
4. A message should pop-up allowing you to select your PIEGA connect plus (Stereo Hub).
Alternatively, you can add a new device by pressing «+» in the upper area of the screen.
5. Follow the instructions on the app to complete the installation.

Note: If the setup with Google Home fails, we recommend using the «RESET» function on the rear panel of your PIEGA connect plus. Restarting your smart device might also help.

6 WIRELESS CONNECTION TO YOUR SPEAKERS

The «GROUP» function is only required when using several PIEGA wireless systems (more than one PIEGA connect plus). The music signal is only sent to speakers within the same group. This ensures the smooth operation of up to three independent PIEGA wireless systems in one room/flat/house.

6.1 CONFIGURE THE SPEAKER GROUP

Make sure to set the same colour «GROUP» on your PIEGA connect plus and your Premium Wireless speaker. As long as you're using just one PIEGA connect plus, you are free to choose any colour: white, blue, or red.

PIEGA CONNECT PLUS

Press «PAIR/GROUP» for at least 3 sec. to make a colour selection.

The «GROUP» indicator confirms the selected group.

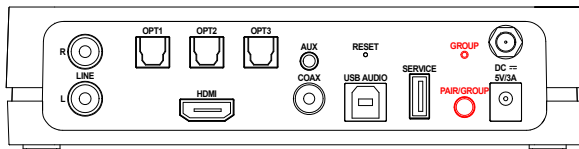

Once the colours match on both units, the connection is being established automatically.

PIEGA PREMIUM WIRELESS LOUDSPEAKER

PIEGA Premium Wireless loudspeaker
Flip the switch to select the desired group.

The «GROUP» indicator confirms the selected group.

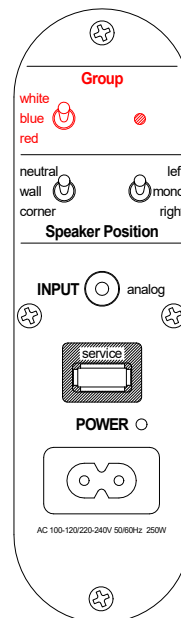

6.2 TRI-BAND 2.4/5.2/5.8GHZ

For wireless signal transmission (music ➡ PIEGA connect plus to loudspeaker) the following frequencies are used: 2.4/5.2/5.8GHz (tri-band). Your PIEGA connect plus automatically selects the best suited frequency to ensure the best possible wireless transmission at all times.

7 CONNECT YOUR REMOTE CONTROL

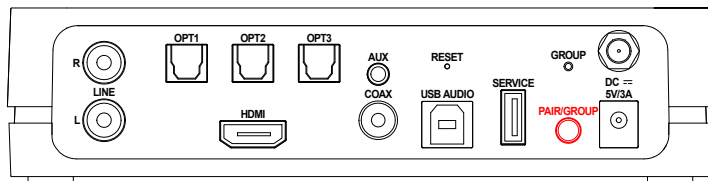

Before the first use, you will have to couple your remote with the PIEGA connect plus.

- Press the «PAIR/GROUP» button on your PIEGA connect plus 2 × shortly to start the pairing process.
- Then press any button on your remote.
- The two units are now successfully connected.

8 TV CONNECTIVITY OPTIONS

8.1 HDMI ARC CONNECTION

If your TV has an HDMI ARC output you can easily and conveniently connect your PIEGA connect plus by connecting your TV to the «HDMI ARC» input on your PIEGA connect plus.

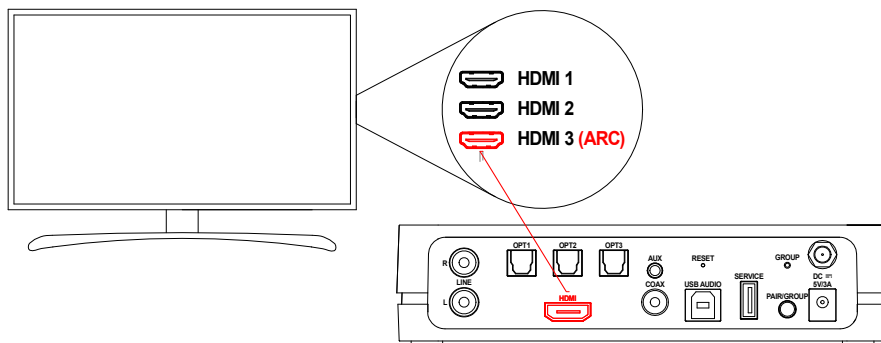

Double-check the settings on your TV to make sure the sound is played back through the HDMI ARC output. The HDMI output must be configured to PCM format.

9 BLUETOOTH CONNECTION

In addition to the integrated streaming clients, you can also connect your smart device directly via Bluetooth to the PIEGA connect plus:

- Press «PAIR» on your remote control.
- The «PAIR» indicator starts blinking.
- From the Bluetooth settings on your device select PIEGA connect plus and start connecting.

Note: Bluetooth is played via «STREAM».

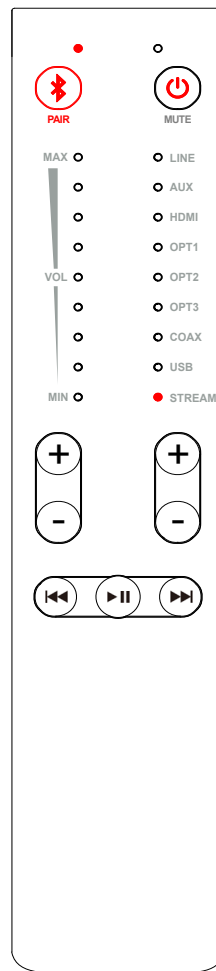

10 MUTE / ON / OFF

- The system can be muted (MUTE) by briefly pressing «POWER ON/OFF» .
- The «MUTE» indicator starts flashing to confirm the mute status.
- Press the button for approx. 2 sec. to switch off your PIEGA connect plus.
- Briefly pressing «ON/OFF» again restarts the system.

11 INPUT SOURCE SELECTION

Use your remote control to select the input source of your choice.

Exception: When streaming (e.g. Spotify Connect), the PIEGA connect plus automatically switches to the «STREAM» input.

Once the streaming is stopped, the PIEGA connect plus automatically falls back to the previously used input source.

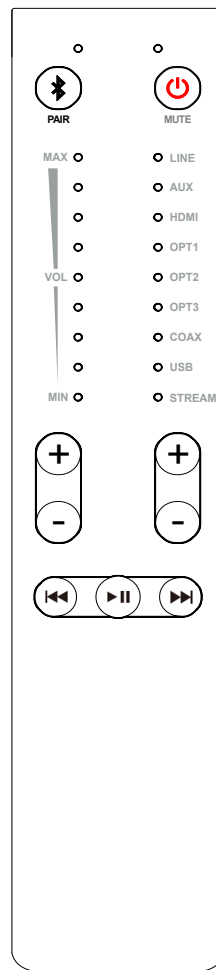

12 FIRMWARE UPDATE

Firmware updates are usually installed via Google Chromecast running automatically in the background. If you wish to update the firmware of your PIEGA connect plus manually, follow the steps below:

13 TECHNICAL DATA

Supported streaming protocols

Google Chromecast
Apple AirPlay
Spotify Connect (incl. Spotify HiFi)
DLNA
Bluetooth 4.2

Network module (WiFi)

WLAN Standard	IEEE 802.11a/b/g/n & 802.11ac Dual Band 2.4GHz / 5.8GHz
Maximum resolution	192kHz (24bit)

KleerNet (PIEGA connect plus to PIEGA Premium Wireless speakers)

Data rate	48 – 96kHz* / 24bit
Tri-band	2.4 / 5.2 / 5.8GHz (auto band switching)

* group red only

Wired inputs

Analog (stereo)	RCA	
Analog (stereo)	3.5 mm Jack	
(3x) Optical (S/PDIF)	Toslink	192kHz /24bit
Coax (S/PDIF)	RCA	192kHz /24bit
HDMI ARC	HDMI	192kHz /24bit
USB Audio	Type B	192kHz /24bit

Supply

External AC adapter	100 – 240V 50/60Hz, 5V @ 3A
---------------------	-----------------------------

Dimensions

Dimensions	172 × 101 × 42 mm
Weight	350 g

14 DECLARATION OF CONFORMITY

PIEGA AMP/speaker is in conformity with the following directives:

LVD:2014/35/EU
EMC:2014/30/EU
RED:2014/53/EU
ERP:2009/125/EU
ROHS:2011/65/EU
REACH:1907/2006/CE

STANDBY

After 60 minutes without any incoming music, the device will automatically go into a network standby mode. This is indicated by a red light on operating status display, and the power consumption goes down to 0.5 W. The device will automatically wake up upon receiving a music signal, but we encourage you to completely turn off your device when not in use for an extended period of time.